

System No. WW-D-1127

October 5, 2013

Assembly Rating — 3 Hr

Nominal Joint Width - 2 - 3-3/8 in.

Class II and III Movement Capabilities - (A) 50 % Compression or Extension or (B) 50% Compression or 25% Extension (See Item 2)

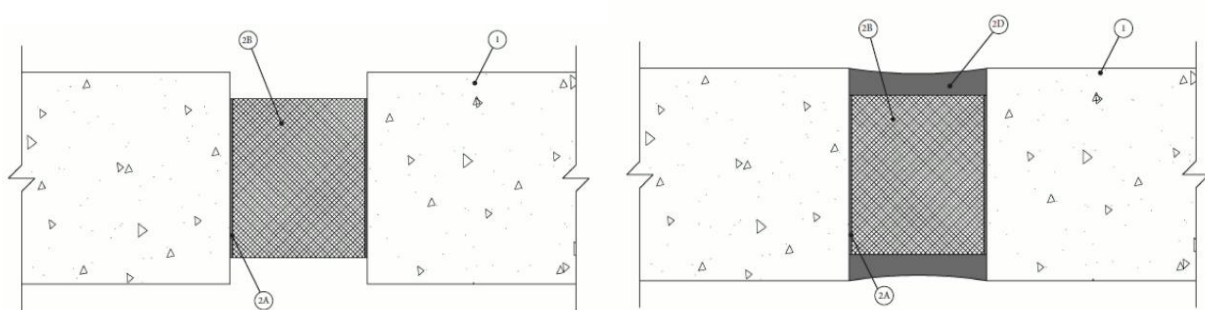

1. **Wall Assembly** — Min 4-1/2 in. (114 mm) thick reinforced lightweight or normal weight (100-150 pcf or 1600-2400 kg/m³) structural concrete. Wall may also be constructed of any UL Classified **Concrete Blocks***.

See **Concrete Blocks** (CAZT) category in the Fire Resistance Directory for names of manufacturers.

2. **Joint System** — (A) Nominal width of joint is 2 to 3 in. (50 to 76 mm). The joint system is designed to accommodate a max 50 percent compression or extension from its installed width. (B) Nominal width of joint is 2 to 3-3/8 in. (51 to 86 mm). The joint system is designed to accommodate a max 50 percent compression or 25 percent extension from its installed width. The joint system shall consist of the following:

Configuration A:

A. **Epoxy Adhesive** — Consists of two parts; part A (base), and part B (hardener) or one part gun grade adhesive. The adhesive is supplied by joint system manufacturer, and installed in accordance with installation instructions.

B. **Mechanical Joint Assembly*** — Compressed, fire-retardant impregnated, 4 in. (102 mm) deep foam. Foam is installed in joint opening as a permanent form.

WILLSEAL L L C — FR Joint, FR Joint UC

Configuration B:

A. **Epoxy Adhesive** — Consists of two parts; part A (base), and part B (hardener) or one part gun grade adhesive. The adhesive is supplied by joint system manufacturer, and installed in accordance with the accompanying installation instructions.

B. **Mechanical Joint Assembly*** — Compressed, fire-retardant impregnated, 4 in. (102 mm) deep foam. Foam is installed in joint opening as a permanent form recessed from surface of wall to accommodate the thickness of sealant Item 2D.

WILLSEAL L L C — FR Joint UC

C. **Packing Material** — Foam backer rod firmly packed into opening as a permanent form. Packing material to be recessed from one or both surfaces of wall as required to accommodate the required thickness of sealant band.

D. **Sealant Band** — Watertight 1/2 in. (13 mm) deep sealant band and corner bead supplied by joint system manufacturer, and installed on one or both sides in accordance with the accompanying installation instructions.

*Bearing the UL Classification Mark

Reprinted from the Online Certifications Directory with permission from UL

© 2013 UL LLC

